

掛式薄膜 細胞培養皿

cellQART® Cell Culture Inserts (TransWell)



Cell Culture Insert
濾膜品質的保證
與Well plate 一起使用
獨家設計
更貼近模擬環境

你一定要試試!

cellQART® Inserts 應用於研究

- **Co-Cultures** 不同細胞群間相互作用
- **Endothelial cell culture** 支持生長及選擇性滲透屏障
- **Epithelial cell cultures** 極佳的支持培養及氣液界面
- **Air-liquid interface (ALI)** 模擬氣液界面 (ALI) 探討呼吸道相關研究
- **Invasion assays** 細胞侵襲能力測定
- **Migration assays** 細胞遷移測定
- **Neurite outgrowth** 區分神經突與細胞體，以研究神經突形成和排斥
- **3D cell culture** 模擬體內環境以及器官或組織的3D生長環境和相互作用
- **Tissue engineering** 模擬組織屏障
- **Transport and permeability studies** 用於研究跨屏障組織界面的傳輸和滲透性
- **Transepithelial-Transendothelial Electrical Resistance (TEER)**
跨上皮-跨內皮電阻監測在insert上生長的組織模型完整性，研究組織受損的疾病



產品資訊

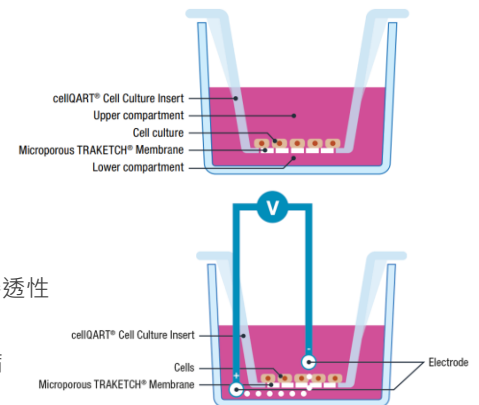

cellQART® Inserts 獨特設計及優點



- 獨特三角式設計更易於pipette操作
- 適用於市面上大部分細胞培養盤
- Insert設計獨特壓痕，上蓋與insert間距優化，更利於氣體交換
- Insert孔洞密度、與well plate底部間距經設計，貼近於模擬環境
- 無 RNase / DNase且無熱原
- 確保100%的膜一致性，使結果具再現性
- 符合DIN EN ISO 9001 and DIN EN ISO 13485及ISO class 8 cleanroom classification認證規範

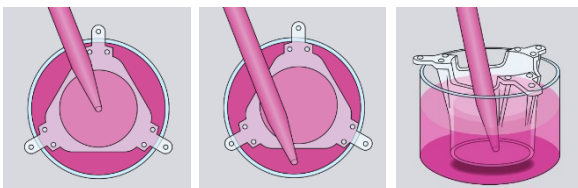

cellQART® Insert的獨特設計，提供適當空間便於pipette操作



降低頂部邊緣，可方便 pipette操作

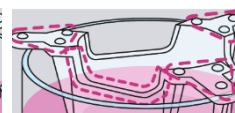

邊緣三角加上壓花點提供
更多氣體交換



cellQART® Inserts和培養
底部well距離 ≥ 1 mm

cellQART®

made by SABEU

 富利瀚生物科技有限公司
FoliBio Technology Co., Ltd.



www.folibio.com.tw
產品專線: (02)2731-9370

搭配專用盤

cellQART® Well Plates

穩定insert · 減少移動造成的實驗影響

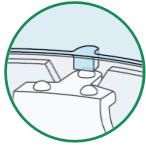

cellQART® 專用盤上蓋
對應底盤凹槽位置 · 設計卡榫

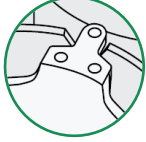

cellQART® 專用盤底盤
底盤對應insert三角位置 · 設計凹槽



cellQART® 專用盤底盤
well與鄰近well的凹槽錯開 · 避免insert移動時碰撞

如何選擇？

1. 選擇孔徑及膜類型

| 膜類型 | 透明 PET Clear PET | 透明延伸培養 PET Clear extended culture PET | 半透明 PET Translucent PET |
|--------|---|---|---|
| 孔徑 | 2 x 10 ⁶ 個孔洞 / cm ² | 4 x 10 ⁶ 個孔洞 / cm ² | 100 x 10 ⁶ 個孔洞 / cm ² |
| 0.4 μm | 2 x 10 ⁶ 個孔洞 / cm ² | 4 x 10 ⁶ 個孔洞 / cm ² | 100 x 10 ⁶ 個孔洞 / cm ² |
| 1 μm | 2 x 10 ⁶ 個孔洞 / cm ² | - | 2 x 10 ⁶ 個孔洞 / cm ² |
| 3 μm | 0.6 x 10 ⁶ 個孔洞 / cm ² | - | 2 x 10 ⁶ 個孔洞 / cm ² |
| 5 μm | 0.6 x 10 ⁶ 個孔洞 / cm ² | - | 0.6 x 10 ⁶ 個孔洞 / cm ² |
| 8 μm | 0.1 x 10 ⁶ 個孔洞 / cm ² | - | 0.2 x 10 ⁶ 個孔洞 / cm ² |

2. well大小

| Well size | 面積 |
|-----------|---------------------|
| 6 well | 4.5 cm ² |
| 12 well | 1.1 cm ² |
| 24 well | 0.3 cm ² |

3. 品項及包裝

| 品項 | 包裝 |
|----------------------|------------------------------|
| 單買insert | 48 pk /box |
| plate + Fully Insert | 4 plates 每盤inserts 裝一半 |
| plate + Half Insert | 4 plates 每盤inserts 裝滿 |
| 單買 plate | 4 plates |

產品列表

Single PET Insert

| 產品 | 膜類型 | 孔徑 | 貨號 | 包裝 | 產品 | 膜類型 | 孔徑 | 貨號 | 包裝 | 產品 | 膜類型 | 孔徑 | 貨號 | 包裝 | | | | | | |
|---------------|--------------------------|----------------|---------|------------|----------------|------------|--------------------------|---------|------------|----------------|----------------|------------|--------------------------|------------|--------|---------|------------|----------------|--------|---------|
| 6 well Insert | Clear透明 | 0.4 μm | 9300412 | 48 pk /box | 12 well insert | Clear透明 | 0.4 μm | 9310412 | 48 pk /box | 24 well insert | Clear透明 | 0.4 μm | 9320412 | 48 pk /box | | | | | | |
| | | 1 μm | 9301012 | | | | 1 μm | 9311012 | | | | 1 μm | 9321012 | | | | | | | |
| | | 3 μm | 9303012 | | | | 3 μm | 9313012 | | | | 3 μm | 9323012 | | | | | | | |
| | | 5 μm | 9305012 | | | | 5 μm | 9315012 | | | | 5 μm | 9325012 | | | | | | | |
| | | 8 μm | 9308012 | | | | 8 μm | 9318012 | | | | 8 μm | 9328012 | | | | | | | |
| | Clear透明 extended culture | 0.4 μm | 9300422 | | | 48 pk /box | Clear透明 extended culture | 0.4 μm | | | 9310422 | 48 pk /box | Clear透明 extended culture | | 0.4 μm | 9320422 | 48 pk /box | | | |
| | | Translucent半透明 | 0.4 μm | | | | | 9300402 | | | Translucent半透明 | | | | 0.4 μm | 9310402 | | Translucent半透明 | 0.4 μm | 9320402 |
| | | | 1 μm | | | | | 9301002 | | | | | | | 1 μm | 9311002 | | | 1 μm | 9321002 |
| | | | 3 μm | | | | | 9303002 | | | | | | | 3 μm | 9313002 | | | 3 μm | 9323002 |
| | | | 5 μm | | | | | 9305002 | | | | | | | 5 μm | 9315002 | | | 5 μm | 9325002 |
| | | 8 μm | 9308002 | | | | | 8 μm | | | 9318002 | | | | 8 μm | 9328002 | | | | |

Fully pre-loaded well plate

| 產品 | 膜類型 | 孔徑 | 貨號 | 包裝 |
|------------------------|--------------------------|--------|---------|-------------------------------------|
| 6 well insert + plate | Clear透明 | 0.4 μm | 9300414 | 6 Inserts per Plate Total 4 Plates |
| | Clear透明 extended culture | 0.4 μm | 9300424 | |
| | Translucent半透明 | 0.4 μm | 9300404 | |
| | | 1 μm | 9301004 | |
| 12 well insert + plate | Clear透明 | 0.4 μm | 9310414 | 12 Inserts per Plate Total 4 Plates |
| | Clear透明 extended culture | 0.4 μm | 9310424 | |
| | Translucent半透明 | 0.4 μm | 9310404 | |
| | | 1 μm | 9311004 | |
| 24 well insert + plate | Clear透明 | 0.4 μm | 9320414 | 24 Inserts per Plate Total 4 Plates |
| | Clear透明 extended culture | 0.4 μm | 9320424 | |
| | Translucent半透明 | 0.4 μm | 9320404 | |
| | | 1 μm | 9321004 | |

Half pre-loaded well plate

| 產品 | 膜類型 | 孔徑 | 貨號 | 包裝 |
|------------------------|--------------------------|----------------|---------|-------------------------------------|
| 24 well insert + plate | Clear透明 | 0.4 μm | 9320416 | 12 Inserts per Plate Total 4 Plates |
| | | 1 μm | 9321016 | |
| | Clear透明 extended culture | 0.4 μm | 9320426 | |
| | | Translucent半透明 | 0.4 μm | |
| | | 1 μm | 9321006 | |

Well plate for insert專用盤

| 產品 | 貨號 | 包裝 |
|---------------|---------|----------|
| 6 well plate | 9300002 | 4 Plates |
| 12 well plate | 9310002 | 4 Plates |
| 24 well plate | 9320002 | 4 Plates |

多項應用並發表高點數文獻

● Co-cultures

CD8+ T-Cells and Immune Checkpoint Inhibitors Potentiates Coagulation and Promotes Metabolic Remodeling—New Cues on CAT-VTE. *Cells* **13**, 305 (2024).

● Migration/Invasion assays

Sclerostin Alters Tumor Cell Characteristics of Oral Squamous Cell Carcinoma and May Be a Key Player in Local Bone Invasion. *Cells* **13**, 137 (2024).

● Tissue engineering

Advanced pathophysiology mimicking lung models for accelerated drug discovery. *Biomaterials Research* **27**, 35 (2023).

Intrathecal Activity of Follicular Helper T Cells in Patients With Relapsing-Remitting Multiple Sclerosis. *Neurol.-Neuroimmunol. Neuroinflammation* **9**, (2022).

● Epithelial cell cultures

Activation-neutral gene editing of tonsillar CD4 T cells for functional studies in human ex vivo tonsil cultures. *Cell Rep. Methods* **4**, (2024).

● Enzymatic degradation tests

A pH-stable, mucin based nanoparticle system for the co-delivery of hydrophobic and hydrophilic drugs. *Int. J. Biol. Macromol.* **215**, 102–112 (2022).

● Organoids

Mpox virus infects and injures human kidney organoids, but responding to antiviral treatment. *Cell Discov.* **9**, 1–4 (2023).

● Organotypic cultures

Organotypic culture of human brain explants as a preclinical model for AI-driven antiviral studies. *EMBO Mol Med.* (2024)